

EZee Life™

Classic Travel Scooter User Manual



EZee Life™ Products

Specifications:

Speed – Adjustable up to 4 mph (6 kph)

Weight – 67lbs (28kg)

Tires – Flat Free Polyurethane 200 x 50 (8" x 2")

Dimensions – 22" W x 41" L x 34" H (57 cm X 104 cm X 86 cm)

Turning Radius – 45" (115 cm)

Drive Type – Front wheel drive

Power Supply – 24 volts by two 12 volt deep cycle rechargeable batteries

Standard Batteries – 12 volt, 7.2 amp hours

Optional Batteries – 12 volt, 12 amp hours

Charge Time – 7 to 10 hours

Battery Charger – Universal 110V – 240 V AC

Travel Range – 4 to 5 miles (6.4 km to 8 km) standard batteries

5 to 7.5 miles (8 km to 12 km) optional batteries

Range will vary depending on user weight, battery condition and terrain

Maximum Slope – 6 degrees (10%)

Maximum Curb Height – 2" (5cm)

Weight Capacity – 250 lbs (113.6 kgs)

Warranty – 1 Year limited parts and labour

Features:

Compact and light

Sturdy enough to be the primary scooter for a 113 kg (250 lbs) person

The Classic folds effortlessly in seconds

The complete disassembly of the Classic is done without tools

The front column is detachable from the base without bending

The battery pack is removable by lifting a handle positioned at hip height

The Classic can be transported in the trunk of any standard family car

Leave your scooter in the trunk just bring the battery indoors for recharging

The Classic may be checked-in with your airline

Batteries are Air Travel Friendly

There are no heavy ground-level parts to be lifted

Limited Warranty:

EZee Life™ products carry a one year warranty against manufacturing defects, faulty materials and workmanship only.

Any alterations, misuse, abuse, or accidental damage voids this warranty. EZee Life™ reserves the right to replace or repair any part that has become defective.

The warranty does not extend to consequential costs resulting from the fault or defect of the product: freight and travel costs, loss of earnings, or other expenses that one may incur.

Warranty is valid for the original purchaser only and the original receipt must be presented before any warranty options are considered. Please also be prepared to provide the date of purchase and serial number.

Introduction

The EZee Classic mobility scooter is intended for use by individuals that are able to walk, but suffer from mild mobility limitations.

The user must have sufficient arm and leg strength to get on and off the on their own and to safely steer under all driving conditions.

The Classic is intended for indoor and restricted outdoor use on pavements or paved footpaths only during daylight hours.

The EZee Classic must not be used as a transportation vehicle on roads or freeways used by cars.

The EZee Classic scooter does not have lights and reflectors and therefore must not be used in the dark or in limited visibility conditions.

Safety

During your initial use of the EZee Classic we recommend caution as you practice operating the unit in various situations. Keep the speed at a reduced level until you are comfortable controlling the scooter.

Follow the safety tips and instructions and you will be comfortable maneuvering through doorways, on and off lifts, over moderate terrain and up and down ramps.





Safety (continued)

These safety considerations and tips will help you to operate the EZee Classic mobility scooter safely. Scooters are powerful electric vehicles and these rules will help you prevent personal injury and damage to your scooter.

1. Read this manual and all labels before operating.
2. Do not carry passengers or exceed the maximum weight capacity.
3. Do not mount or dismount the EZee Classic unless it has come to a full stop and is turned off.
4. Do not back up on to uneven inclines or surfaces.
5. Always switch the speed selector to low when driving in a confined space.
6. Always reduce speed when turning.
7. Do not operate your scooter when under the influence of alcohol, medications or drugs that may impair your safety.
8. Always keep your feet on the foot platform when driving.
9. Do not sit on the scooter while being transported in a moving vehicle.
10. Always secure your scooter when being transported in a vehicle.

Control Panel

- | | |
|-------------------------|--------------------------|
| 1. On-Off Switch | 4. Indicator light (LED) |
| 2. Hand control lever | 5. Battery Gauge |
| 3. Speed adjusting knob | 6. Hand-grips |



EZee Classic Parts

1. Battery pack (detachable)
2. Front column (detachable)
3. Column lock/release triggers
4. Controller cover
5. Charging socket (Fig. 1A)
6. Front drive wheels
7. Foot platform
8. Seat shell
9. Seat cushions
11. Rear wheel
12. Folded frame lock/release pin
13. Unfolded frame lock/release pin
14. Utility basket (holding capacity 20lbs/9kg)
15. Charger and connecting cables (Fig. 1B)
16. Control Panel
17. Freewheel switch



Figure 1

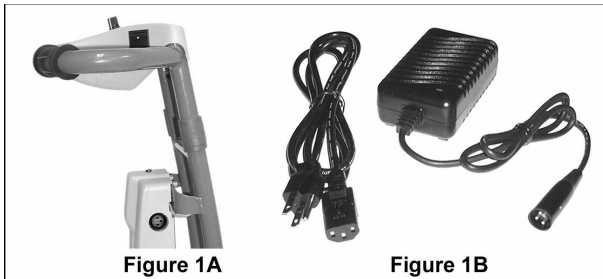

Figure 1A



Figure 1B





Assembly Instructions

Unfolding Rear Frame

Pull on the folded frame lock pin ring (Fig. 4/1) to release the foot platform and unfold the frame.

Pull the seat backrest (Fig. 4/2) and lift it to the upright position. Ensure that the unfolded frame lock pin secures the platform in the horizontal position.

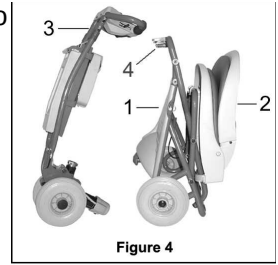

Figure 4

Unfolding Front Column

Pull the column lock trigger (Fig. 4/3) upward towards the handle to release the tilt lock.

Move the drive unit away from the column (all the way) to open the quick-release housing. This is the column “detach” position.

Connecting the Front Column to the Rear Frame

Position the column in the “detach” position. Lift the front of the foot platform and insert connection pin into the quick-release housing on the drive unit.

This may be done without bending down by lifting the front of the seat “lip” while holding the front column handgrip as shown in Fig. 5.



Figure 5

Front Column Adjustment (Figure 6)

To adjust the angle of the front column, pull the column lock trigger upward. Move the column into the desired position and release. Push lightly back and forth on the column to ensure that it is locked in the desired position.

1. For driving the EZee Classic adjust column to the rear-most position.
2. For getting in and out of the EZee Classic seat comfortably, the column may be moved away from the seat to the entry/exit position.
3. For detaching the front column from the rear frame, adjust the column fully forward to the detach position (Fig. 6/3); remove battery before adjusting the column to the detach position.



Figure 6

CAUTION: When getting in and out of the EZee Classic seat, step only on **CENTER** of foot platform. **DO NOT STEP ON SIDE OF FOOTPLATFORM** to avoid tipping the scooter.

NOTE: The rear frame, when folded, can be lifted by the handles (Fig 4/4).

Folding Your EZee Classic

Step 1: Fold backrest of seat down (Fig. 7/1)

Step 2: Hold handgrip of front column (Fig. 7/2) in the “Operating” or “Entry/Exit” position and push forward away from seat to fold platform upwards.

Step 3: Grasp platform handle (Fig. 7/3) and pull column lock triggers (Fig. 7/4) to fold column towards the platform. Fold together until folded lock pin (Fig. 7/5) and column latch (Fig. 7/6) click into place and hold the EZee Classic in folded position.

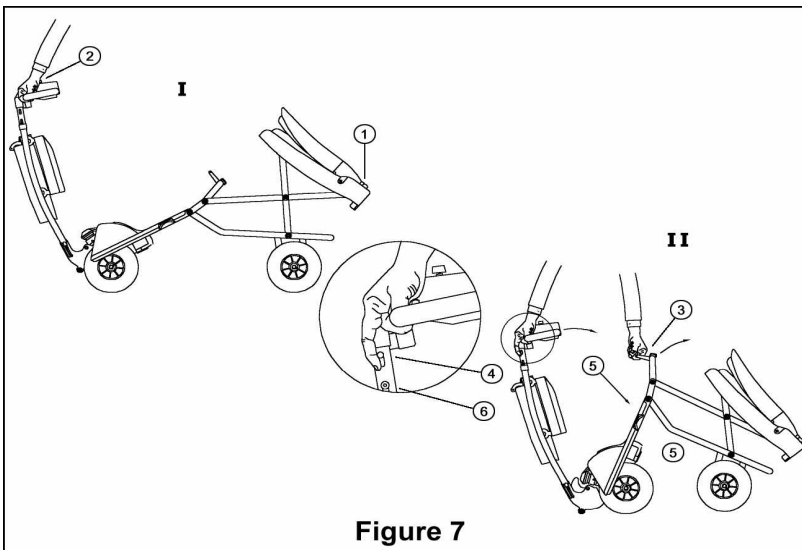

Figure 7



Unfolding Your EZee Classic

Step 1: Pull on the frame lock pin ring (Fig. 8/1) to release platform and rest front wheels on floor. Step 2: Pull the seat backrest and lift it upright. (Fig. 8/2)

Step 3: Grasp top of seat backrest (Fig. 8/3) and pull column lock triggers (Fig. 8/4) to release column from platform. Pull outwards to unfold Easy Fold Deluxe until platform and column lock into the operating position.

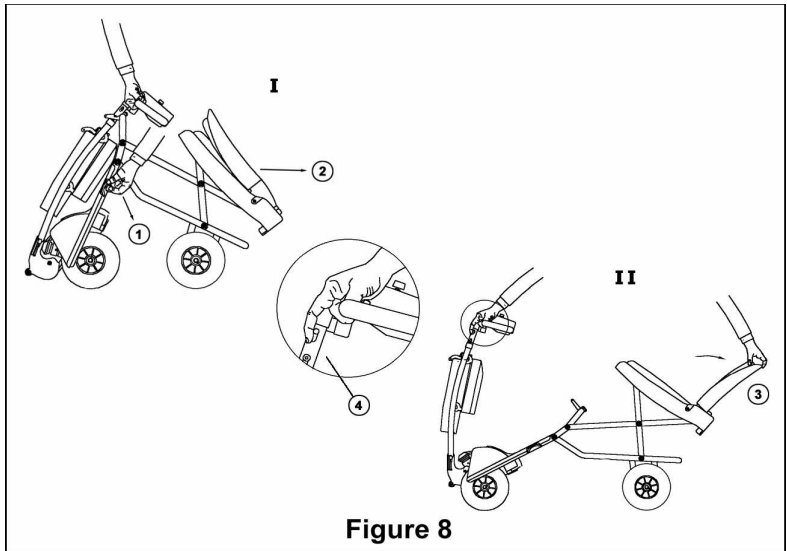

Control panel operation features

The switch located on the right side of the handle control cover (Fig. 9/1) will turn the power of the EZee Classic ON or OFF.

NOTE: Turn your EZee Classic switch to the OFF position when not in use in order to conserve battery power and prevent unintentional operation.

The top speed may be adjusted by turning the speed-adjusting knob (fig 9/3).

By turning the knob to the HI position, your EZee Classic top speed will be up to 4mph / 6kph.

When the knob is set to the LO position, the speed will be reduced to a slow pace, ideal for less experienced drivers and for operating indoors.



Figure 9

Indicator Light (Fig 9/4)

Indicator light steady - This indicates that all is well.

Indicator light flashes slowly - The controller is functioning correctly but batteries should be charged as soon as possible. The Battery Gauge (Fig. 9/5) shows the charge that is left the user and provide more clearance under the foot plates.

Indicator light flashes quickly - This indicates a possible fault. Please follow the following procedure.

1. Switch off the EZee Classic
2. Make sure the EZee Classic is not in the FREEWHEEL position.
3. Make sure that the charger is not connected to the EZee Classic.
4. Make sure that the control lever is in the middle position.

CAUTION: If control lever does not return by itself to the middle position - do not operate. Contact your service agent.

5. Switch the EZee Classic on again and check the indicator light. If it flashes rapidly again, switch off and do not operate. Contact your dealer or a service centre.

Battery Gauge (Fig. 9/5)

The Battery Gauge (Fig. 9/5) shows the battery charge that is left.



Driving Your EZee Classic

To drive forward, pull the right side of the hand control lever towards you (Fig. 10/1). You can also move forward by pushing the left side of the control lever away from you. By releasing the control lever, you will gradually come to a stop, and the EZee Classic brake will be applied automatically. To operate in reverse, pull the left side of the hand control lever towards you (Fig. 10/2).

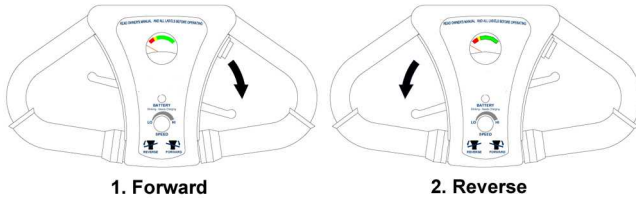

Figure 10

Safety considerations when driving

- 1) Footpaths and sidewalks appear to be level but are usually slightly sloped for drainage of rainwater. Counter-steering may be necessary for overcoming excessive slopes. In such cases the speed should be reduced as necessary.
- 2) When approaching ditches, bumps or similar obstacles – reduce speed as necessary.
- 3) Do not operate EZee Classic in places or on surfaces where a loss of wheel grip could be hazardous, for example on wet grassy slopes.

Armrests (optional)

To enable easier entry to and exit from your EZee Classic the armrest can be lifted, see Fig. 10A.



Figure 10 A

Battery Information

The EZee Classic is designed to use sealed lead acid, maintenance-free, 12V batteries.

Always turn your EZee Classic OFF before removing and installing batteries. To get the maximum out of your batteries, it is recommended to fully charge the batteries overnight after every day of use. **Reconnecting the charger when the batteries are partially discharged or fully charged will not harm them.** Extended charging is good for the batteries and you cannot overcharge them.

Battery range depends on operator weight, terrain and the condition of batteries used. Charge your batteries daily and/or overnight when the Easy Fold Deluxe is not in use.

Battery Charging Instructions

To recharge, turn off Easy Fold Deluxe. It is possible to either charge the battery while connected on the Easy Fold Deluxe (see instruction 1 below) or directly (instruction 2).

1. Plug the charging connector into the EZee Classic charging socket and then connect the charger to an electrical outlet socket.
2. Plug the charging connector in the back of the battery pack and then connect the charger to an electrical outlet socket.

During charging, the indicator light on the charger will be red. When the battery is approaching full charge the indicator light will turn green. In order to achieve the maximum battery capacity and efficiency, it is advised to charge them overnight, and at least four hours after the indicator light has turned to green.

Battery Safety Instructions

CAUTION: Failure to follow these instructions may result in personal injury or property damage.

1. Never smoke or allow an open flame in the vicinity of the batteries.
2. Use the charger for charging lead acid batteries only. It is not intended to supply power to an extra-low-voltage electrical system or to charge dry cell batteries.
3. Never charge a frozen battery.
4. Do not operate the charger in a closed-in area or restrict ventilation.

Battery Safety Instructions (continued)

5. Prevent external damage to AC and DC cords. Do not use charger if cords are damaged.
6. Connect DC charging cord to the Charging Socket before connecting charger AC supply cord to the electrical outlet, and disconnect the AC cord from the electrical outlet before disconnecting charge cord.
7. Be extra cautious not to drop a metal object onto the battery case.
8. Remove jewelry.

Battery Storage

Before storage, battery packs should be fully charged, and should be recharged at least once every three months.

Store batteries indoors in a dry environment.

Storage temperature range: -20°C (-4°F) to 40°C (104°F)

Charging temperature range: 0°C (32°F) to 40°C (104°F)

Operating temperature range: -20°C (-4°F) to 50°C (122°F)

WARNING: Store batteries in the 'correct' position. (See Fig. 14).

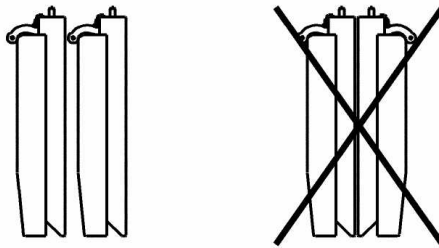

Figure 14

Battery Replacement and Disposal

The Easy Fold Deluxe battery pack contains two 12V maintenance-free batteries. Replacement batteries must be purchased from an authorized dealer.

Battery cells may emit minor acid fumes.



Battery Replacement and Disposal (continued)

Batteries must be recycled. Disposals of potentially damaged batteries present hazards of injury from acid leakage and environmental pollution.

NOTE: When removing a battery, always set it on cardboard, newspaper, or surfaces that cannot be damaged by acid fumes or liquid from the battery.

Moving and Transporting Your EZee Classic

1) Moving the Classic in freewheel when unfolded

The freewheel switch (Fig. 1/17) is used for releasing the brake and moving the EZee Classic without operating the motor. Before activating, make sure your EZee Classic is switched on. Turn Freewheel switch to the "freewheel" position and push or pull the EZee Classic manually.

NOTE: The Freewheel mode can only be activated after the battery is in place and the power switch (Fig.9/1) is turned on. Doing otherwise will cause a fault situation indicated by rapid flashing of the Indicator light (Fig. 9/4). See section 4.2.

WARNING: The Freewheel switch should never be engaged on a slope when EZee Classic is occupied and without assistance to prevent unintended rolling. If Freewheel is activated on a slope unintentionally, turn your EZee Classic power switch OFF immediately to activate brake.

CAUTION: The seat back must remain in the upright position.

2) "Walking" your EZee Classic when Folded

The folded EZee Classic may be pulled along suitcase style.

The battery should be carried separately (Fig. 11) or in the utility basket. See folding instructions on page 7.

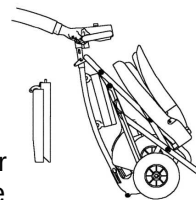

Figure 11



3) Transporting the EZee Classic Quickly and Easily

Your EZee Classic can be disassembled and transported in most car trunks.

When disassembling for transportation or storage: 1. Disconnect battery pack and place in Utility basket (Fig. 12/1)

2. Disconnect front column (Fig. 12/2) and fold rear frame separately (Fig. 12/3)

3. For storage – set down front column in a stable position.

4. For transportation, place EZee Classic components in car trunk as shown in figure 13.



Figure 12



Figure 13

Helpful Hints

Before using your Easy Fold Deluxe take the following precautions:

- Ensure that the front column and rear frame are locked together.
- Ensure that the rear frame is locked open.

Speed Controls

Operate your EZee Classic at a reasonable speed for both your personal safety and others. Do not make sharp turns at high speeds or on inclines.

Ramps and Inclines

Lean forward and carefully maneuver your scooter up a ramp or incline. Be aware that not all ramps are constructed according to government standards. The government standard for wheelchair ramps is 1 inch (2.5 cm.) rise per foot (30 cm).

Lower the speed setting to a slow speed when descending inclines.

Using an Elevator

Backing into an elevator allows you to exit forward. Be sure that the elevator is level with the floor.

Opening Doors

When a door opens towards you, approach at an angle and just off to one side. Adjust the speed knob to a low setting. Grasp the doorknob, reverse and pull the door open.

For doors that open away from you, position the front roller against the door, close to the doorjamb on the doorknob side of the door.

After you release the latch, use the roller to push the door open.

WARNING: Be careful with glass doors to avoid personal injury!

General Maintenance and Inspections

Basic maintenance should prevent unnecessary repairs.

Keep Your Easy Fold Deluxe Shining

Wipe the seat clean with a damp cloth. Protect the painted parts with a coat of auto wax.

WARNING: Water or excessive moisture around the controller unit or electrical connections may cause contamination of electrical circuitry, damage and malfunction as well as personal injury. Do not leave your EZee Classic in the rain or in excessively humid locations.

Daily Checks

With the EZee Classic switched off, check that the hand control lever mechanism returns to the rest position when you push and release. If there is a problem do not use the EZee Classic and contact your authorized dealer.

Weekly Checks

1) Throttle test: Pull the throttle to the full speed position and switch ON the Power switch. The EZee Classic should not move and the LED on the panel should flash. If the EZee Classic does move – do not use y EZee Classic. Contact your authorized dealer.



Weekly Checks (continued)

2) Automatic brake and drive test: This test should be carried out on a level surface with at least 3' / 1 m. clear space around the EZee Classic

- a) Switch the EZee Classic on.
- b) Move the control lever only slightly in the forward direction until you hear a "click" when the brake disengages. The EZee Classic should start to move forward slowly.
- c) Immediately release the throttle. You must be able to hear a "click" when the brake engages back, within a few seconds.
- d) Repeat the test in the reverse direction. If you do not hear the brake operating, or the EZee Classic does not move slowly in the expected direction – do not use your EZee Classic. Contact your authorized dealer.

Monthly Care

Clean upholstery, plastic and metal parts with a mild surface cleaner.

CAUTION: Keep cleaning solvents away from electrical wires and connectors.

Six Month Maintenance

- 1) Apply a lubricant/cleaner (such as WD40 or similar) these locations:
 - a) Column tilt lock pin and housing.
 - b) Unfolded lock pin and housing.
 - c) Battery pack lock pins.
- 2) Lightly apply Vaseline or similar lubricant to battery contact pins and springs on front column.
- 3) Check for tire wear.

Fuse Information

The electric circuits of the EZee Classic are provided with two overload protection fuses. Replacement of the fuses is only permitted to an authorized technician. Both fuses are commercially available automotive-blade type.

Location of the fuses

- a) Battery Pack fuse 20A, - Within Battery pack
- b) Control circuit fuse 1A, – Underneath controller cover

NOTE: Fuses of a different rating should not be used!

WARNING: Do not attempt to repair or service the EZee Classic or any of its components, as this will void your warranty.

SERVICE AND REPAIR: CONTACT YOUR AUTHORIZED DEALER.

EMI – ELECTROMAGNETIC INTERFERENCE

CAUTION: It is important that you read this information regarding the possible effects of electromagnetic interference on your EZee Classic.

Motorized scooters may be susceptible to electromagnetic interference (EMI), which is interfering electromagnetic energy (EM) emitted from sources such as radio stations, TV stations, amateur radio (HAM) transmitters, two-way radios, and cellular phones. The interference (from radio wave sources) can cause scooters to release their brakes, come to a sudden stop, or move in an uncontrolled manner. It can also permanently damage a scooter's control system. The intensity of the interfering EM energy can be measured in volts per meter (V/m). Each Motorized scooter can resist EMI up to a certain intensity. This is called its "immunity level". The higher the immunity level, the greater the protection. The FDA has stated that all newly manufactured electric mobility vehicle models should have a resistance of at least 20 V/m, which would provide a reasonable degree of protection from the more common sources of radiated EMI.

Your EZee Classic, as shipped, with no further modification, has an immunity level of 20 V/m. This immunity was tested with the inclusion of these accessories: a utility basket with a spare battery-pack and the charger unit carried in-side it.

There are a number of sources of relatively intense electromagnetic fields in the everyday environment. Some of these sources are obvious and easy to avoid. Others are not apparent and exposure is unavoidable. However, we believe that by following the warnings listed below, your risk to EMI will be minimized.

The sources of radiated EMI can be broadly classified into 3 types:

- 1) Hand-held portable transceivers (transmitters-receivers) with the antenna mounted directly on the transmitting unit. Examples include citizens band (CB) radios, "walkie-talkies", security, fire, and police transceivers, cellular telephones, and other personal communication devices. ****NOTE:** Some cellular telephones and similar devices transmit signals while they are ON, even when not being used;
- 2) Medium-range mobile transceivers, such as those used in police cars, fire trucks, ambulances, and taxis. These usually have the antenna mounted on the outside of the vehicle; and
- 3) Long-range transmitters and transceivers, such as commercial broad-cast transmitters (radio and TV broadcast antenna towers) and amateur (HAM) radios.

NOTE: Other types of hand-held devices, such as cordless phones, laptop computers, AM/FM radios, TV sets, CD players, and cassette players, and small appliances, such as electric shavers and hair dryers, so far as we know, are not likely to cause EMI problems to motorized scooters.

Motorized scooter Electromagnetic Interference (EMI)

Because EM energy rapidly becomes more intense as one moves closer to the transmitting antenna (source), the EM fields from hand-held radio wave sources (transceivers) are of special concern.

It is possible to unintentionally bring high levels of EM energy very close to the motorized scooter's control system while using these devices. This can affect the scooter's movement and braking. Therefore, the warnings listed below are recommended to pre-vent possible interference with the control system of your EZee Classic.

WARNINGS

Electromagnetic interference (EMI) from sources such as radio and TV stations, amateur radio (HAM) transmitters, two-way radios, and cellular phones can affect motorized scooters. Following the warnings listed below should reduce the chance of unintended brake release or powered wheelchair movement, which could result in serious injury.

- 1) Do not operate hand-held transceivers (transmitters-receivers), such as citizens band (CB) radios, or turn ON personal communication devices, such as cellular phones, while your EZee Classic is turned ON;
- 2) Be aware of nearby transmitters, such as radio or TV stations, and try to avoid coming close to them;
- 3) If unintended movement or brake release occurs, turn your EZee Classic power switch OFF as soon as it is safe to do so;
- 4) Be aware that adding accessories or components, or modifying your EZee Classic, may make it more susceptible to EMI (Note: There is no easy way to evaluate their effect on the overall immunity of your EZee Classic);
- 5) Report all incidents of unintended movement or brake release to your Authorized EZee Classic dealer or service centre, and note whether there is a source of EMI nearby.





Fault Finding

Instructions

Problem		Check point
The driving of the scooter is too slow or insufficient, the status indicator lamp flashes slowly		Batteries are exhausted and need to be recharged
The EZee Classic does not function, the Battery/Status indicator flashes rapidly. Count the number of flashes:	1 Flash	The battery needs charging or there is a bad connection to the battery. Check the connections to the battery or charge batteries.
	2 Flashes	There is a bad connection to the motor. Check all connections between the motor and the controller.
	3 Flashes	The motor has a short circuit to a battery connection.
	4 Flashes	Freewheel is engaged.
	5 Flashes	Not used.
	6 Flashes	The controller is being inhibited from driving; this may be because the battery charger is connected.
	7 Flashes	A throttle fault is indicated. Make sure that the throttle is in the rest position before switching on the scooter
	8 Flashes	A controller fault is indicated. Make sure the controller connections are secure.
	9 Flashes	The parking brakes have a bad connection. Check the parking brake and motor connections. Make sure the controller connections are secure.
	10 Flashes	An excessive voltage has been applied to the controller. This is usually caused by a poor battery connection. Check the battery packs and controller connections.

Disposal and Recycling

- 1) The packing material must be separated to plastic and paper/cardboard components and submitted to authorized recycling locations.
- 2) The EZee Classic device consists of electronic components, cables, plastic parts, steel and aluminium frame and adapter parts. Do not discard of any components to normal garbage facilities. When EZee Classic is no longer operational, it is to be dismantled and separated into above material groups and submitted to authorized recycling facilities.

For safety and for warranty assurance reasons, any modifications and repair of the EZee Classic or its components must be performed exclusively by authorized personnel and exclusively with original spare parts.

The EZee Classic and its accessories have been designed, manufactured and tested in accordance with the specification of the following:
DIRECTIVE: Medical devices 93/42 EEC

Your Dealer:

Distributed by:

Factory Direct Medical
34 Futurity Gate, Unit 15
Concord, Ontario L4K 1S6
Local Phone: 416-739-8393
Toll-Free : 855-235-2400